

44

44

BARRPH

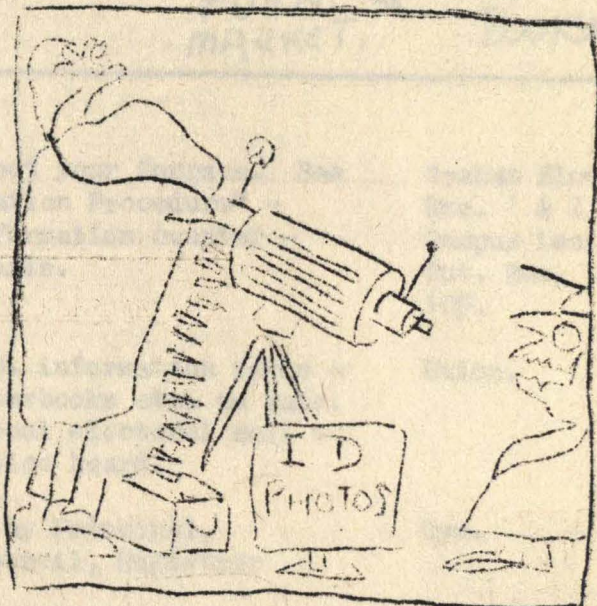
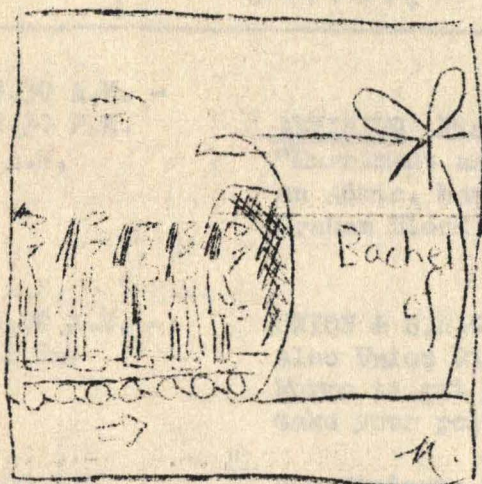

Vol. 3

No. 1

28-2-77

ORIENTATION WEEK PROGRAMME

MONDAY 28th FEBRUARY

- 4 A.M. Student Reps. meet Students arriving by Train - and take them by Bus to Union for Hot Drinks and Biscuits.
- 9 A.M. - 5 P.M. "ACCOMMODATION DAY" - Get your Accommodation lined up - all day.

Wagga
Railway
Station

TUESDAY 1st MARCH

- 9.30 A.M. Union Furniture Market opens - to sell cheap 2nd hand furniture to full time students (only) all day.

Old Machinery
shed between
Uni-Co-Op
Bookshop &
Principal's
Office past
labs, Main
Campus.

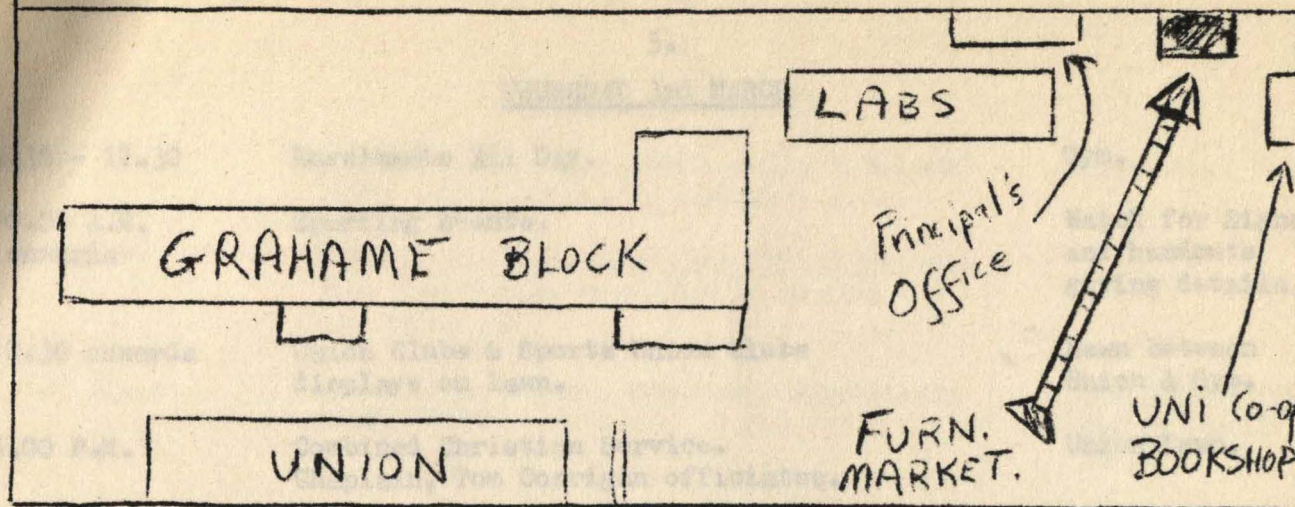

9.30 A.M. -
12.30 P.M.

ADVISING Find out about your Courses. See "Enrolment and Orientation Procedure" - an Admin. handout (information counter - Graham Block) for details.

Graham Block Lec. Rms. 1 & 2 North Campus Lec. Rm. 1, Tut. Rms. 104 & 109.

10.00 A.M. -
All Day

UNION & S.R.C. & A.U.S. information table - also Union Diaries, Yearbooks etc. on sale. Forms to get you on local electoral roll - make your political voice heard.

Union.

3.00 P.M.

New Students welcomed by Principal, Chairman of College Council, Registrar and Deans.

Gym.

8.30 P.M.

Film Club presents Four underground Aussie Flicks and one big box office attraction.

Auditorium.
South Campus.

"O LUCKY MAN" (Malcolm McDowell)

"Castor & Pollux" - (Bikies & Hippies)

"Brakefluid" - (Humour - an innocent love affair amongst the trendies.)

"People Don't Talk About It" - (Documentary on Masturbation) - graphic sequences.

"Speed Queen" - (Sex and Drugs!)

WEDNESDAY 2nd MARCH

9.30 - 12.30)
1.30 - 4.30)

Enrolments All Day

Gym.

1.00 P.M.

Bus Tour of sights around Wagga, arriving Library, South Campus at 2 p.m.

Leaves Pinegully Rd., behind Gym.

2.00 P.M.

Guided tour of Library - (very useful!) Bus brings everyone back from Library to arrive main Campus at 3.00 p.m.

8.00 P.M.

Folk Night. Folk Artists perform - Student Reps. from Union, S.R.C. & Sports Union welcome new students. Bar open until midnight! Cheese and biscuits provided.

Union

THURSDAY 3rd MARCH

9.30 - 12.30	Enrolments All Day.	Gym.
10.00 A.M. onwards	Sporting Events.	Watch for Signs and handouts giving details.
12.30 onwards	Union Clubs & Sports Union Clubs displays on lawn.	Lawn between Union & Gym.
5.00 P.M.	Combined Christian Service. Chaplain, Tom Corrigan officiates.	Union Lawn.
5.00 P.M.	Bus leaves Pinegully Rd. outside Gym. for South Campus. It will drop off those in the <u>PUB CRAWL</u> at <u>Black Swan Hotel</u> - North Wagga.	

PUB CRAWL PUB CRAWL PUB CRAWL PUB CRAWL

Black Swan Hotel to William Farrer (see map
overleaf) 5.15 onwards. Pick up forms from Union Offices
or at Bar 12 - 2 p.m. Middy in each of the 14 Pubs.
Regular buses go down main street and up Edward Street to
South Campus at 6.15 p.m. & 8.15 p.m., to
Main Campus at 6.30 p.m. & 8.30 p.m.

9.00 P.M.	Folk Spectacular featuring the one and only MIKE McLELLAND	Auditorium South Campus 9.00 p.m. \$1.00
	(If you're on the pub crawl - flag down the 8.15 p.m. bus in Edward Street near the William Farrer.)	

FRIDAY 4th MARCH

9.30 - 12.30 } 1.30 - 4.30 }	Enrolments all day	Gym.
10.30 A.M.	Window painting competition. Anyone is eligible to go in this zany competition to "decorate" a window at Meaghers. Magnums of champagne from Meaghers big Andy Capp grog section - as prizes. (For most imaginative & energetic decorators")	Meaghers Super Store - Gurwood St. near Fitzmaurice St. (next to Coles).
12.30 P.M.	Surf Carnival presented by Sports Union. Novelty Races (fully clothed race, basketball-butting, breaststroke-race, pyjama relay, kickboard derby, apple bobbing, etc. etc.)	College Pool.
9.00 P.M.	AUS Campus Activities (AUSEA) present —— D E L U V I A —— a mime and music night. <u>John Paul Bell & John Summers</u> A unique and fascinating evening of entertainment.	Auditorium - South Campus. 50 ¢

SATURDAY 5th MARCH

1.30 P.M. Concert & Barbeque (Meat, Rolls & Salads) Lawn near Pool.
 FREE. Starring I. C. Daylight.

AFTERNOON Wagga's Big Raft Race finishes at reserve -
 just downstream from Hampden Bridge.
 Big Occasion.

9.00 P.M. Fancy Dress Dance, starring Kindergarten Old Dining Hall -
 Kool. BYOG. South Campus
 50

SUNDAY 6th MARCH

2.00 A.M. Daylight Saving Ends. Everywhere
 except Queensland.

7.30 P.M. Film Club presents "Girl Crazy"
 - "Now for Something Completely Different"
 Monty Python. AUDITORIUM
 Note 7.30 is the regular Wintertime South Campus
 starting time for double features. 50
 Single features will always commence
 at 8.00 p.m.

PUB CRAWL
MAP

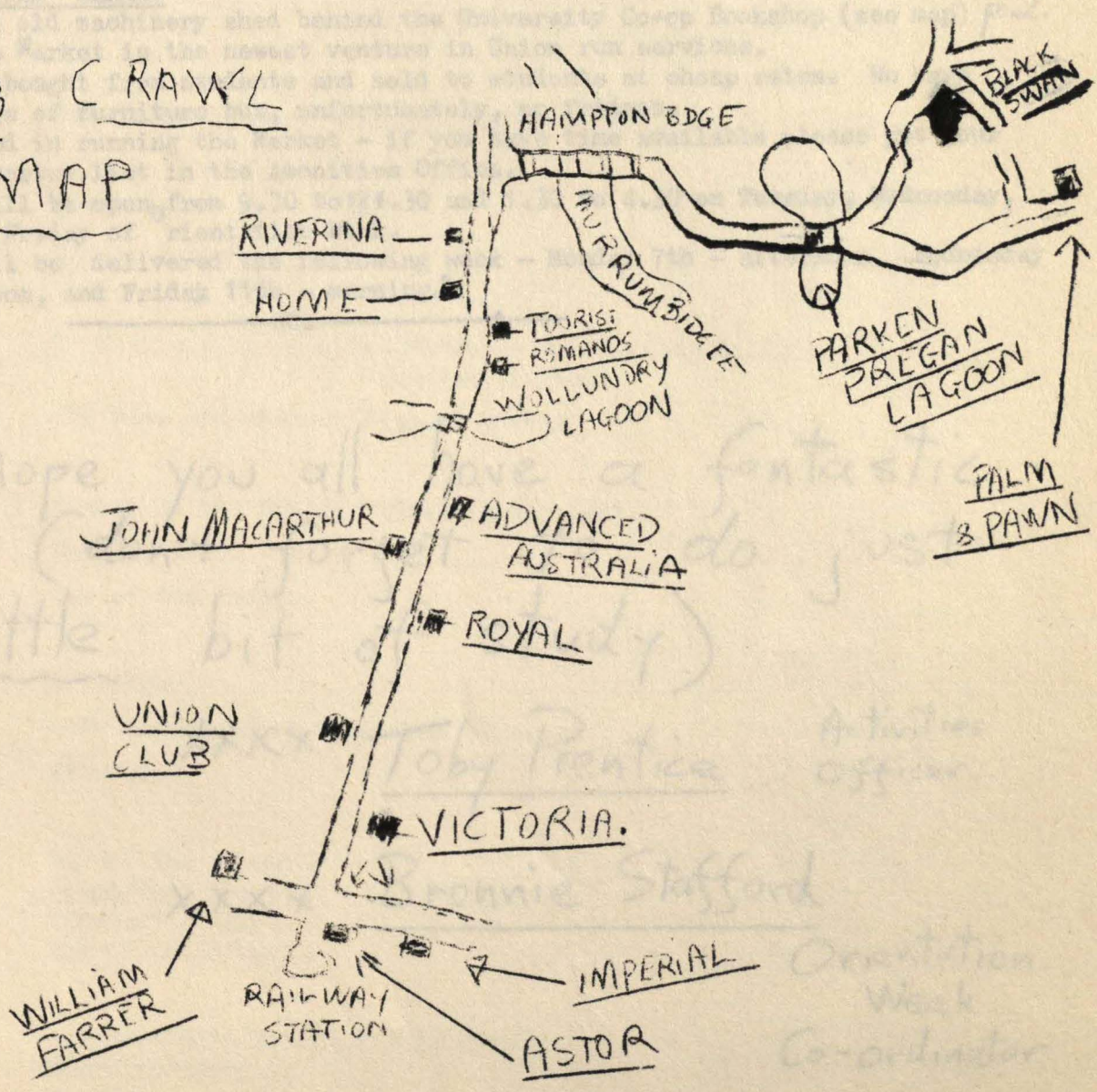

CO-OP

This is a Union run venture aimed at offering students cheap goods. The Co-Op has recently been moved to the Main Campus and is now under the management of Henry Hounsell. Henry has a new approach to this retail outlet and there is a greater variety of goods available i.e. health foods, meat, grocery goods, second hand books, clothing etc.

The Co-Op will continue to offer goods at prices undercutting those available in town as long as students patronise this service. The Co-Op is a non-profit service and only aims to break even.

Should you wish to make any suggestions re new food lines see Henry who will be only too pleased to help.

REMEMBER: by shopping at the Co-Op you are saving yourself and your fellow students money and you can do all your shopping in one spot.

Full price list will be available in next week's BARPH.

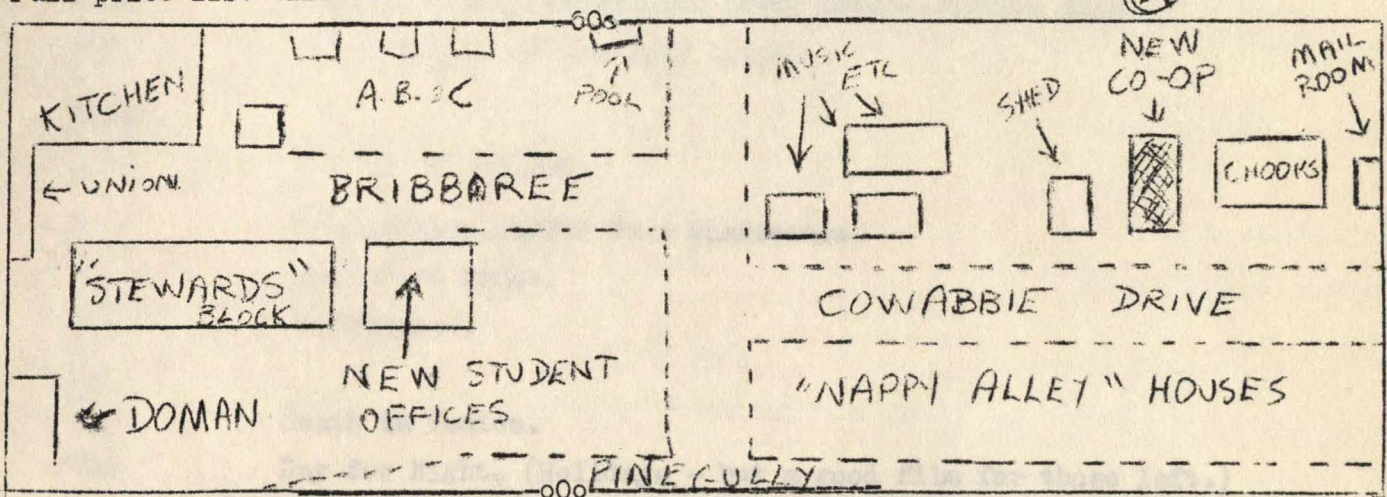

UNION FURNITURE MARKET

Located in an old machinery shed behind the University Co-op Bookshop (see map) p.2. the Furniture Market is the newest venture in Union run services.

Furniture is bought from students and sold to students at cheap rates. We have a large range of furniture but, unfortunately, no fridges.

Help is needed in running the Market - if you have time available please put your name on the roster list in the Amenities Office.

The Market will be open from 9.30 to 12.30 and 1.30 to 4.30 on Tuesday, Wednesday, Thursday and Friday of orientation Week.

Furniture will be delivered the following week - Monday 7th - afternoon, Wednesday 9th - afternoon, and Friday 11th - morning.

We hope you all have a fantastic year (don't forget to do just a little bit of study)

XXXX Toby Prentice Activities Officer.

XXXX Bronnie Stafford Orientation Week Co-ordinator

XXXX Dave Purchase A.U.S Officer (SRC)

UNION FILM CLUB SCREENINGS

EVERY SEMESTER SUNDAY - AUDITORIUM SOUTH CAMPUS - 50¢

Times - 8.00 p.m. for Single Billing
7.30 p.m. for Double Billing

MARCH

- 6th Girl Crazy/Monty Python - and now for something completely different.
13th The Boys in the Band.
20th Flesh for Frankenstein/The Rocky Horror Picture Show.
27th Monty Python and the Holy Grail.

APRIL

- 3rd That'll be the Day.
10th Blazing Saddles/The Four Musketeers.
17th Harold and Maude.
24th Performance.

MAY

- 1st Death in Venice.
8th Day for Night. (Holidays - but a good film for those left.)
22nd The Great Gatsby/The French Connection.
29th If.

JUNE

- 5th The Stranger (The Outsider)/Blind Terror.
12th Picnic at Hanging Rock.
19th Chinatown.
26th Uptown Saturday Night.

JULY

- 3rd To Kill a Mockingbird/Adventures of Sherlock Holme's Smarter Brother.
31st The Rise and Rise of Michael Rimmer.

AUGUST

- 7th Murder on the Orient Express/Lucky Lady.
14th Between Wars.
21st Day of the Jackal.

SEPTEMBER

- 11th Dillinger.
18th Life and Times of Judge Roy Bean.
25th Petersen.

OCTOBER

- 2nd Day of the Locust.
9th Frogs/Taxi Driver.
16th Rosemary's Baby.
23rd Way of the Dragon.

NOVEMBER

- 6th The Candidate/Diary of Anne Frank.
13th The Hindenburg.
20th TheDove.
27th Flash Gordon.

DECEMBER.

- 3rd Earthquake.

STUDENT DISCOUNTS AVAILABLE IN WAGGA (on presentation of I.D.)

Photographic Supplies

Paul Bayley's 155c Baylis St 10%

Hairdressers

Hair'em Fitzmaurice St(next to Georges) 30%(Tues&Wed)

Books

Hunters 68 Fitzmaurice St 10% (textbooks)

Gateway Bookshop South Town Walk 10%

Cremers Forsyth St 10%(art supplies)

Co-Op Bookshop Main Campus Rebate-if member

Mechanical & Transport

Wagga Wheel Align. Centre 31 Dobney Ave 10%

Hacketts Motors&Woodies Auto Electrical rear 171 Fitzmaurice St 10%

Millers Service Station Fernleigh Rd, Turvey Park by arrangement

Central Wagga Auto Port cnr Trail & Gurwood Sts 1c/litre(petrol)

10% Labour

Jupiter Motors(Kawasaki) 20 Edward St., 10%parts

Jack Skeers (Honda) 115 Fitzmaurice St 10% parts

K.O. Auto Centre Fitzmaurice St() Discount petrol

(opp Col. Saunders) 10% Auto Access.

Cudmores Cycle Centre 107 Fitzmaurice St., 15% parts

10% bikes

Schippers Sports Store 68a Baylis St 10%

Don Jones Tyre Service Hammond Ave by arrangement

Discount Tyres Fitzmaurice St 30%

Windscreens O'Brien 60 Hammond Ave 20% (on glass)

Olympic Way Service Station cnr Olympic Way & Coolamon Rd (\$8/hr labour

20% { \$1 lubrication

{ \$2 puncture rep.

{ \$21 power flush

by arrangement

Howground Motors Bourke St.

+++++